



**GLAZING MASONRY CHANNEL STONE TENSION RODS**

# INTRODUCTION



## HALFEN ANCHOR CHANNELS

For more than 65 years, Halfen anchor channels have been used for a multitude of applications in commercial, institutional and industrial projects worldwide. A full line of pre-engineered systems with built-in adjustability are available for faster, easier installation of building facades, structural components, services and equipment.

Halfen's selection of tee-bolts and channel nuts allows design flexibility and easy installation. Fasteners can be inserted into the slot face anywhere along the length of the channel, then rotated 90 degrees into place. Fasteners are zinc electroplated, with a selected range also available in hot dip galvanized or stainless steel.

Halfen anchor channels are cost competitive, since they accommodate construction tolerances, allow for adjustment during installation, eliminate the need for welding or drilling, and reduce site hazards from welding or projecting bolts.

### TECHNICAL INFO & SPECS

Complete technical information and 3-part specifications are available for download at: [www.halfenusa.com](http://www.halfenusa.com).

CD and 3-ring binder with complete information are also available upon request.

For technical assistance and application support, please contact our engineering department.

**Halfen Anchoing Systems**  
**Phone: 800-323-6896**  
**Fax: 888-277-1695**  
**[halfen@meadowburke.com](mailto:halfen@meadowburke.com)**  
**[www.halfenusa.com](http://www.halfenusa.com)**

Halfen anchor channels have a cold formed or hot rolled channel body with l-anchors welded to the back of the channel. They are available in hot dip galvanized carbon steel, or in stainless steel. The channels are foam filled to prevent concrete from entering the channel.

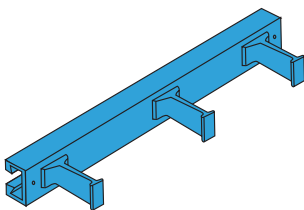
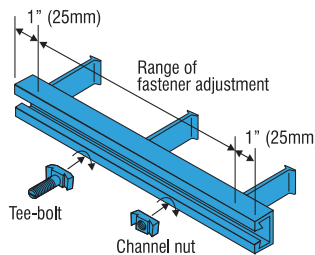

With 11 different profiles, and available lengths from 1 3/4" to 20' [45 to 6,100 mm], anchor channel connections can be supplied to suit most requirements. Using Halfen products, skilled designers can develop structural and secondary connections with dimensional adjustments in one, two or three directions.

# CHANNEL



## CHANNEL PROFILES

Halfen channel profiles provide a versatile connection system when surface mounted or hung from other structural elements. Connections can be made by welding, bolting, screwing or clamping the profiles to back-up elements. Once placed, the channel profiles allow for adjustable fastening points and compensate for tolerance variations.

Halfen's smaller profiles are much more compact than traditional metal framing, but provide comparable loading capacities.

Fastener pull-out and shear loads of up to 9,600 lb [42.7 kN] for the larger Halfen hot-rolled profiles greatly exceed the capacity of common roll-formed metal framing. This feature allows designers to use traditional metal framing application techniques with greater load capacities than afforded by regular metal framing.

Profiles illustrated here [in 1:3 scale] are available in carbon steel, and stainless steel for all types except 5542 and 7248 series. Standard length is 19'-11" [6,070mm].

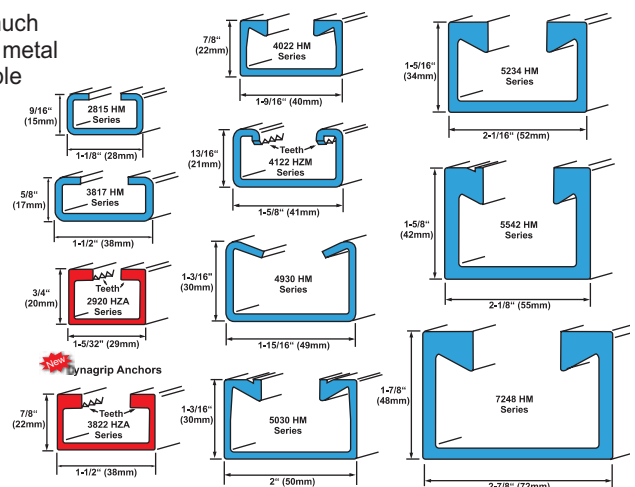

# GLAZING



## ANCHORS FOR CURTAINWALL AND STOREFRONT SYSTEMS

Used on projects worldwide for decades, Halfen anchors provide designers and glazing contractors with reliable, strong, adjustable connections of glazing systems to building structures. Halfen also provides technical support for architects, specifiers, engineers and façade consultants to solve the most complex anchoring challenges.

The curtainwall or storefront frame is then bolted back to the Halfen anchor with twist-in Halfen tee-head bolts. The bolted connection provides tolerance to accommodate on-site adjustment, reduce installation time, and eliminate the high labor costs associated with drilling or welding.

### MULTI-ADJUSTABLE CURTAIN WALL CLIPS & BRACKETS

Halfen multi-adjustable clips for edge of slab applications provide up/down and in/out adjustability. Left and right dead load clips are available with offset horizontal slot to maximize capacity. Wind load clips have vertical slot in projected side to allow for vertical movement of mullion, relative to clips. Three clip sizes are available, to fit most stick curtain wall applications. All clips and washers are extruded from 6005-T5 aluminum.

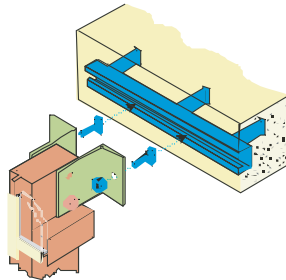

In addition to the standard 12" long anchor channels, the design flexibility of the Halfen system also provides longer embeds for double mullion conditions, or shorter anchors at jambs, plus anchors for corner conditions.

For anchor conditions in very thin concrete elements such as concrete-topped metal decks or where extremely close edge distances preclude the use of regular anchor channels, Halfen can also provide embeds with rebar anchors, or custom design an anchor suitable for the specific application.

Halfen anchor channels are available in a variety of sizes and capacities to suit almost all the curtainwall and storefront anchoring requirements of low, medium and high rise projects. Typically, Halfen anchors 12" [305mm] long are cast into the edge or top of the concrete floor slabs, providing adjustable connections with design capacities from 600 to 17,600 lbs [3 to 78 kN].

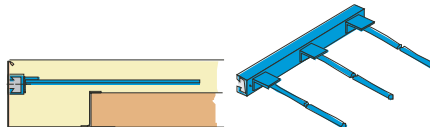

When combined with Halfen embeds and T-bolts, adjustment in all three dimensions can be achieved.

Halfen multi-adjustable clips may also be used with post-installed (drilled) anchors, if embeds are not pre-installed in slab.



New top-of-slab bracket with 3-D adjustability for unitized curtain wall. All-steel construction brackets are available in 4 standard sizes, and have dead load and wind load capacity to suit most curtain wall applications.

# HALFEN



## LITERATURE AVAILABLE FROM HALFEN

### GLAZING

- Multi-Adjustable Curtain Wall Clips
- Anchors for Glazing
- Top of Slab Bracket for Curtain Wall

### MASONRY

- Adjustable Concealed Lintel Systems
- Anchors for Masonry
- Fleming Masonry Veneer Restraint System

### STONE

- Anchors for Stonework
- HRM Stone Fixing Clips

### PRECAST

- Anchors for Precast Panels
- Application Details Anchors for Precast
- Double Tee Stem Anchors

### STAINLESS

- Halfen Products for Corrosive Environments

### TENSION RODS

- Detan Tension Rod System

### SOFTWARE

- AnkerCalc 1.1
- Anker CAD

### TECHNICAL

- Dynagrip Toothed Anchor Channels
- Halfen Technical Manual (Anchor Channels, T-bolts & Profiles)

### SPECS

- CSI 3-Part Specifications
- Product Data Sheets

### Available Formats

- Hard Copy Catalogs
- CD-Rom
- Website



DISCLAIMER: This brochure outlines the Halfen products intended for use in the North American marketplace, or on projects where North American design parameters have been used. All application illustrations shown in this publication are for guidance only and should not be taken as working drawings. Halfen reserves the right to amend, withdraw or make changes to products and specifications at any time with out written notice to customers, designers and users. It is the policy of Halfen Anchoring Systems to work with designers, specifiers, engineers and contractors in providing application assistance, suggestions and advice for the satisfactory solution of anchoring problems. However, all advice and drawings provided are subject to the approval of the design team, contractor or structural engineer, who take ultimate responsibility for proper product usage.



A division of Meadow Burke Products • P.O. Box 547 Converse, TX 78109  
Phone: 800-323-6896 or 210-658-4671 • Fax: 888-277-1695 or 210-658-7908  
halfen@meadowburke.com • www.halfenusa.com